

DESIGN (PDU)
ENGINEERING

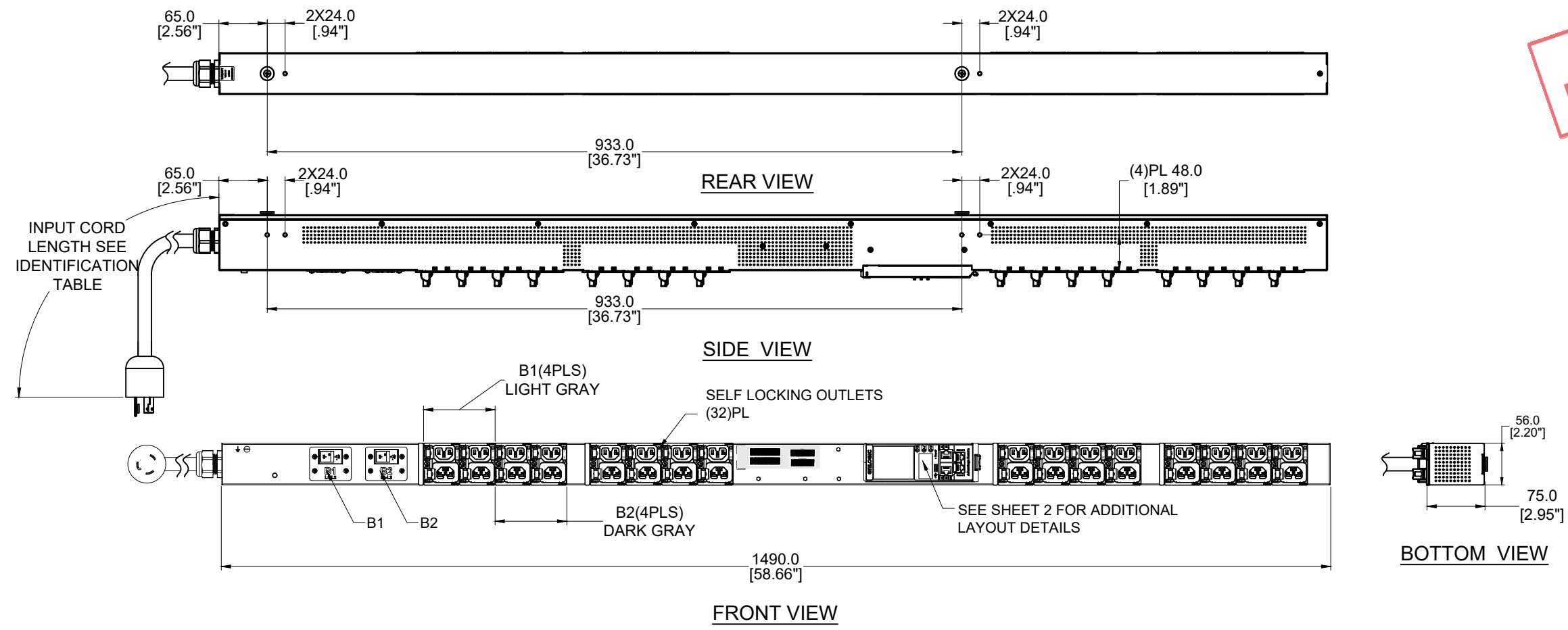

TECHNICAL SPECIFICATIONS	
UNIT TYPE:	MONITORED&SWITCHED PER OULET
ORIENTATION:	VERTICAL, 0U FULL
OUTLET QTY & TYPE:	(16)C13/C15 LOCKING, (16)C13/C15/C19LOCKING
INPUT VOLTAGE:	200-240V
INPUT CURRENT:	30A (24A DERATED)
BREAKER QTY & TYPE:	(2) 20AMP, DOUBLE-POLE, 5KAIC
INPUT PHASE:	SINGLE-PHASE
RATED POWER:	5 KVA
INPUT PLUG:	SEE NOTE 7
INPUT POWER CORD:	SEE IDENTIFICATION TABLE
FEATURES	
METERING ACCURACY	+1% TO ISO/ IEC 62052-21
METERING ATTRIBUTES	VOLTAGE(V), CURRENT(A), APPARENT POWER(KVA), REAL POWER(KW), POWER FACTOR, ENERGY(kWh)
METERED COMPONENTS	INPUT(PHASE), CIRCUIT BREAKERS, OUTLETS
REMOTE OUTLET SWITCHING	YES
ENVIRONMENTAL CONDITIONS	
OPERATING TEMPERATURE	-5 TO 60 C (23 TO 140 F)
STORAGE TEMPERATURE	-20 TO 60 C (-4 TO 140 F)
HUMIDITY (OPERATING/STORAGE)	5-90% RH / 5-95% RH; NON-CONDENSING
MAX OPERATING ELEVATION, ABOVE MSL	3000M(9840FT)
COMPLIANCE	
SAFETY&ENVIRONMENTAL	RoHS COMPLIANT

IDENTIFICATION TABLE	EN6381-*	* INPUT PLUG	* CHASSIS COLOR	* CORD OPTION	* ORIENTATION
MODEL IS SHOWN IN DEFAULT CONFIGURATION. FOR OPTIONAL CONFIGURATIONS, USE ITEM IDENTIFIER CODE IN PLACE OF EACH ASTERISK. ORDERABLE BASED ON FORMAT: EN 6381-****	(DEFAULT) L6-30P = 0	(DEFAULT) BLACK = 0 BLUE = B RED = R GREEN = G WHITE = W YELLOW = Y	(DEFAULT) 1.8m [6'] = 0 1m [3.2'] = 1 2m [6.6'] = 2 3m [10'] = 3	(DEFAULT) TOP FEED = 0 BOTTOM FEED = 2	
OPTIONS LISTED ON THIS ROW ARE NON STANDARD, CONTACT SALES FOR ADDITIONAL INFORMATION		ORANGE = A	0.5m [1.6'] = A 1.5m [4.9'] = B 2.5m [8.2'] = C	1.2m [4'] = G 1.8m [6'] = F	

- NOTES :
- INSTALLATION SHALL COMPLY WITH ALL APPLICABLE NATIONAL, STATE AND LOCAL CODES.
 - PRIMARY DIMENSIONS ARE IN MILLIMETERS. SECONDARY DIMENSIONS ARE IN [INCHES]
 - UNIVERSAL MOUNTING BRACKET IS AN ALTERNATIVE MOUNTING METHOD TO THE TOOLLESS MOUNT FOR 3RD PARTY ENCLOSURES. BRACKET IS PROVIDED WITH THE UNIT.
 - DETAILED INSTALLATION INSTRUCTIONS CAN BE FOUND IN THE QUICK START GUIDE
 - CONNECT EXTERNAL EARTH GROUND TO THE 10-32 SIZE THREADED NUT
 - SEE PRODUCT DOCUMENTATION FOR FURTHER INFORMATION
 - INPUT PLUG CONFIGURATION (SEE IDENTIFICATION TABLE) FOR DUAL-RATED UNITS, NEMA PLUGS ARE NAM RATED ONLY AND CAPTIVE AUS/NZ PLUGS ARE EMEA RATED ONLY

ECN/ECO	REV.	DESCRIPTION	DATE	APPROVED
	E1	INITIAL DRAFT REVIEW	2023/04/19	Leo Liu

THIS DRAWING AND SPECIFICATIONS HEREIN ARE THE PROPERTY OF CIS GLOBAL AND SHALL NOT BE COPIED, REPRODUCED OR USED IN WHOLE OR IN PART, AS THE BASIS FOR THE MANUFACTURE OR SALE OF ITEMS WITHOUT WRITTEN PERMISSION FROM CIS GLOBAL. THIS DRAWING IS BASED UPON LATEST AVAILABLE INFORMATION AND IS SUBJECT TO CHANGE WITHOUT NOTICE

TITLE : Advantage Series
Metered & Switched per outlet

PROJECT : enLOGIC

UNLESS NOTED, DIMENSIONS ARE IN MILLIMETERS & TOLERANCES ARE:
 X ±1 MM X° ±1°
 X.X ±0.5 MM X.X° ±0.5°
 X ±0.20 MM
 Ø X.X ±0.3 MM
 Ø X.XX ±0.10 MM

BRACKETED DIMENSIONS ARE IN INCHES FOR REFERENCE ONLY

⊕ THRID ANGLE PROJECTION
 INTERPRET PER ASME Y14.5M-1994

PART NO: EN6381-WXYZ_DA
REV.: E1

DRAWN BY: Leo Liu 2023/04/19
ENGINEER: Luo Jingbo 2023/04/19
APPROVED BY: Hanson 2023/04/19

SCALE : N/A
 SHEET 1 OF 3
 SIZE: A3

DESIGN (PDU)
ENGINEERING

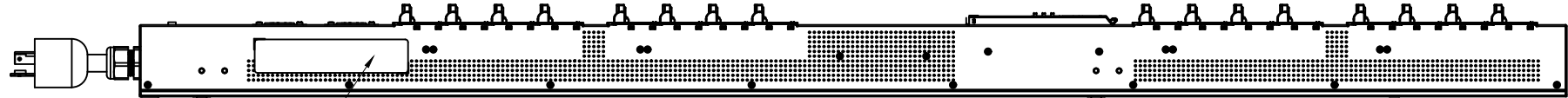

PRODUCT LABEL SIDE VIEW

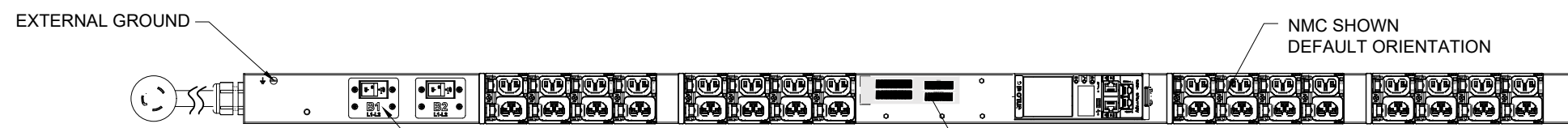

EXTERNAL GROUND 20AMP, DOUBLE-POLE ELECTRO MECHANICAL SWITCH/BREAKER (2) PLACES NMC SHOWN DEFAULT ORIENTATION

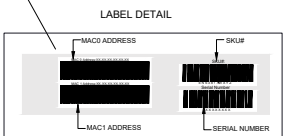

FRONT VIEW LABEL DETAIL

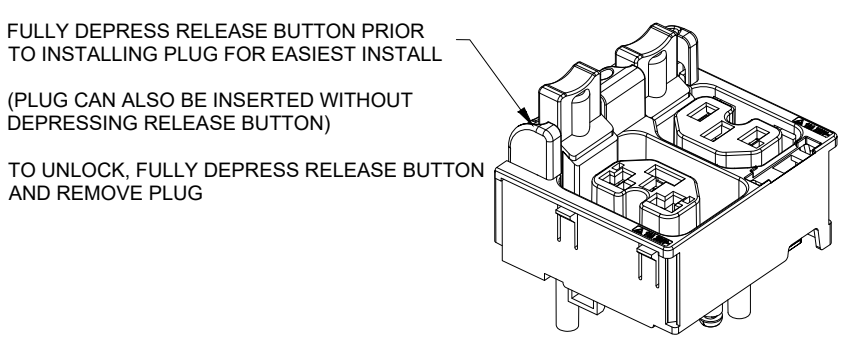

FULLY DEPRESS RELEASE BUTTON PRIOR TO INSTALLING PLUG FOR EASIEST INSTALL
(PLUG CAN ALSO BE INSERTED WITHOUT DEPRESSING RELEASE BUTTON)
TO UNLOCK, FULLY DEPRESS RELEASE BUTTON AND REMOVE PLUG

LOCKING COMBO OUTLET

RECEPTACLE

STANDARD RECEPTACLES

IEC 60320 C13, C15
MAX RATED OUTPUT 10A, 250V

IEC 60320 C13, C15, C19, C21
MAX RATED OUTPUT 16A, 250V

INPUT PLUG

(DEFAULT)

NEMA L6-30P, 2P 3W
30A, 250V MAX RATED INPUT
24A DERATED

OPTIONAL

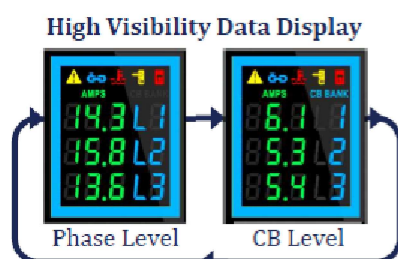

High Visibility Data Display



- Critical Alarm Alerts**
- ▲ PDU Alarm
 - ⚡ Cascade Error
 - 🌡 Environmental Alarm
 - 🔒 Security Alarm
 - 🔧 Circuit Breaker Alarm

Source Color Coding (User Selected Option)



User Interactive Display (for setup and detailed information)

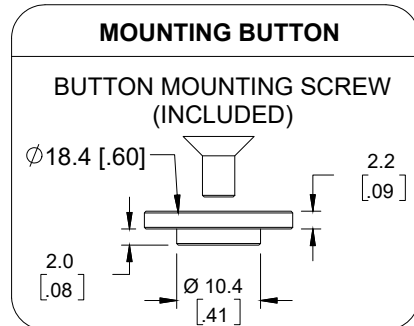

MOUNTING BUTTON

BUTTON MOUNTING SCREW (INCLUDED)

USB-C (upgrades, connectivity, and future-proof expansion)

10/100/Gigabit Ethernet Port (primary network port)

Digital Sensor Port 1 (supports up to 8 physical sensors)

10/100 Ethernet Port (for redundancy and Ethernet cascading)

Digital Sensor Port 2

	E1	INITIAL DRAFT REVIEW	2023/04/19	Leo Liu
ECN/ECO	REV.	DESCRIPTION	DATE	APPROVED

REVISIONS				
TITLE :	UNLESS NOTED, DIMENSIONS ARE IN MILLIMETERS & TOLERANCES ARE:	PART NO:	REV.	
Advantage Series Metered & Switched per outlet	X ±1 MM X° ±1° X.X ±0.5 MM X.X° ±0.5° X ±0.20 MM Ø X.X ±0.3 MM Ø X.XX ±0.10 MM	EN6381-WXYZ_DA	E1	
		DRAWN BY: Leo Liu	2023/04/19	
PROJECT: enLOGIC	BRACKETED DIMENSIONS ARE IN INCHES FOR REFERENCE ONLY THRID ANGLE PROJECTION INTERPRET PER ASME Y14.5M-1994	ENGINEER: Luo Jingbo	2023/04/19	
		APPROVED BY: Hanson	2023/04/13	
		SCALE: N/A	SHEET 2 OF 3	SIZE: A3

enLOGIC by nvent

THIS DRAWING AND SPECIFICATIONS HEREIN ARE THE PROPERTY OF CIS GLOBAL AND SHALL NOT BE COPIED, REPRODUCED OR USED IN WHOLE OR IN PART, AS THE BASIS FOR THE MANUFACTURE OR SALE OF ITEMS WITHOUT WRITTEN PERMISSION FROM CIS GLOBAL. THIS DRAWING IS BASED UPON LATEST AVAILABLE INFORMATION AND IS SUBJECT TO CHANGE WITHOUT NOTICE

- NOTES :**
- INSTALLATION SHALL COMPLY WITH ALL APPLICABLE NATIONAL, STATE AND LOCAL CODES.
 - SEE PRODUCT DOCUMENTATION FOR FURTHER INFORMATION

enLOGIC RACK Power Distribution Unit Made In XXXXX
Metered&Switched per outlet

SKU #: EN6381-WXYZ
 Model #: EP161024-0070-L
 INPUT: 200-240VAC, 1PHASE, 50/60Hz, 24A
 OUTPUT: C13/C15 LOCKING; 200-240VAC, 10A per outlet
 C13/C15/C19 LOCKING; 200-240VAC, 16A max per outlet
 24A Total

MAC0 Address:XX-XX-XX-XX-XX-XX
 MAC1 Address:XX-XX-XX-XX-XX-XX

FC

Serial Number: XXXXXX X X X X

THIS DEVICE COMPLIES WITH PART 15 OF THE FCC RULES. OPERATION IS SUBJECT TO THE FOLLOWING TWO CONDITIONS:
 (1) THIS DEVICE MAY NOT CAUSE HARMFUL INTERFERENCE.
 AND (2) THIS DEVICE MUST ACCEPT ANY INTERFERENCE RECEIVED, INCLUDING INTERFERENCE THAT MAY CAUSE UNDESIRABLE OPERATION. CAN ICES-3(A)/NMB-3(A)

COMPLIANCE LABEL

NOTES:

- 1. INTERNAL WIRING
- WIRE TYPE: UL AWM 1015, 10 & 12 & 18 AWG
- LINE 1/R/X COLOR: Black
- LINE 2/S/Y COLOR: Red
- EARTH GROUND COLOR: Green
- 2.FOR FINISHED GOOD PART NUMBER SEE IDENTIFICATION

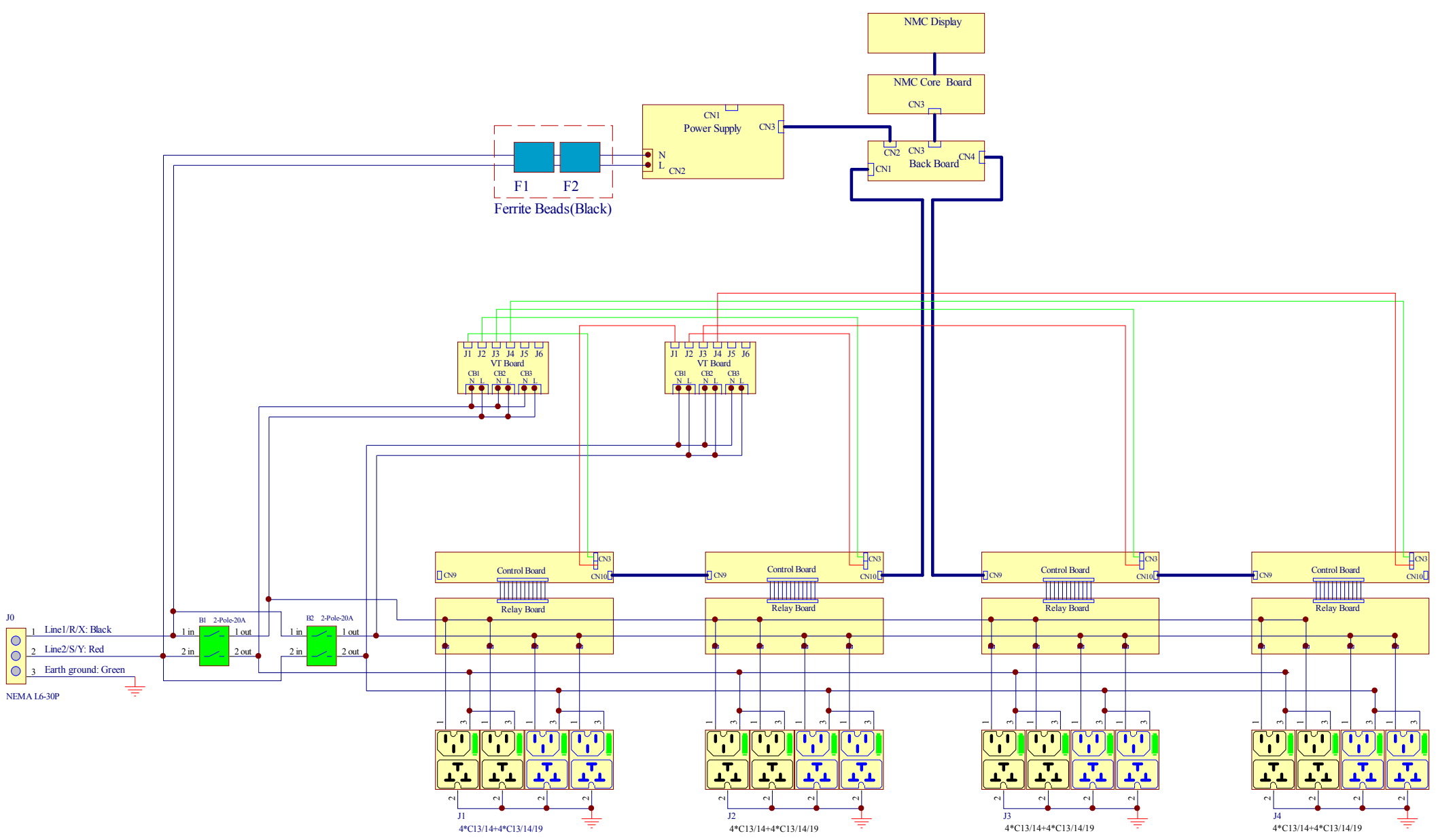
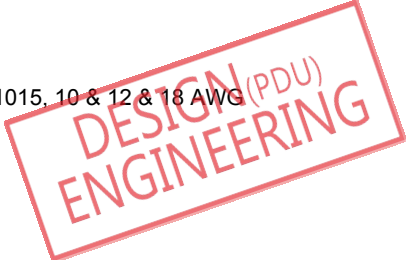

INTERNAL WIRING SCHEMATIC DIAGRAM

- NOTES:
1. INSTALLATION SHALL COMPLY WITH ALL APPLICABLE NATIONAL, STATE AND LOCAL CODES.
 2. SEE PRODUCT DOCUMENTATION FOR FURTHER INFORMATION.
 3. THIS DRAWING DEPICTS THE POWER SYSTEM CONNECTIONS AND IS NOT REPRESENTATIVE OF THE PHYSICAL LAYOUT. PLEASE REFER TO MECHANICAL DRAWINGS FOR PHYSICAL LAYOUT.

enLOGIC by nvent

THIS DRAWING AND SPECIFICATIONS HEREIN ARE THE PROPERTY OF CIS GLOBAL AND SHALL NOT BE COPIED, REPRODUCED OR USED IN WHOLE OR IN PART, AS THE BASIS FOR THE MANUFACTURE OR SALE OF ITEMS WITHOUT WRITTEN PERMISSION FROM CIS GLOBAL. THIS DRAWING IS BASED UPON LATEST AVAILABLE INFORMATION AND IS SUBJECT TO CHANGE WITHOUT NOTICE

	E1	INITIAL DRAFT REVIEW	2023/04/19	Leo Liu
ECN/ECO	REV.	DESCRIPTION	DATE	APPROVED
REVISIONS				
TITLE :		UNLESS NOTED, DIMENSIONS ARE IN MILLIMETERS & TOLERANCES ARE:	PART NO:	REV.
Advantage Series Metered & Switched per outlet		X ±1 MM	EN6381-WXYZ_DA	E1
		X.X ±0.5 MM	DRAWN BY: Leo Liu	2023/04/19
PROJECT : enLOGIC		X ±0.20 MM	ENGINEER: Luo Jingbo	2023/04/19
		Ø X.X ±0.3 MM	APPROVED BY: Hanson	2023/04/13
		BRACKETED DIMENSIONS ARE IN INCHES FOR REFERENCE ONLY	SCALE : N/A	SHEET 3 OF 3
		THIRD ANGLE PROJECTION		SIZE: A3
		INTERPRET PER ASME Y14.5M-1994		